



## FLUO TP

**THE ONLY PAINT THAT DOES NOT CONTAIN CARCINOGENIC, MUTAGENIC, OR TOXIC COMPONENTS FOR REPRODUCTION**

**PAINTS THAT RESPECT MEN AND THE ENVIRONMENT**

**100% USAGE GUARANTEE, NO WASTE**

**UNIQUE AND PATENTED SAFETY CAP :**

**CAN BE USED UP TO -15°C**

- The only locking cap
- A particularly robust safety cap (a full aerosol dropped from a height of 1.50m will remain intact)
- No contact with the paint

**VERY BRIGHT MARKING AND COVERING CAPACITY IN A SINGLE PASS, HIGHLY FLUORESCENT**

**ONLY 2 PICTOGRAMS !**



**7 COLOURS AVAILABLE**



## INSTRUCTIONS FOR USE

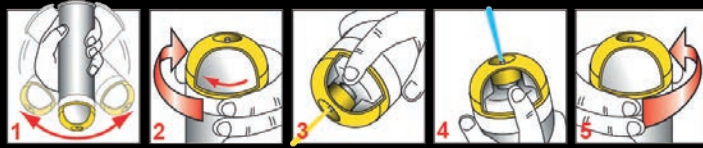

- 1** . Before use : Shake vigorously (balls must be clearly audible)
- 2** . Unlock the aerosol by turning left the safety cap
- 3** . Use Fluo TP® « head down » about 10cm from the support
- 4** . After use, purge « head up » to clean out the valve and the diffuser
- 5** . Lock the aerosol by turning right the safety cap

## HEATH AND SAFETY :

Consult our free safety data sheets on our website [www.soppec-inc.com](http://www.soppec-inc.com)

No paint mist or drips during use

GHS labelling with two pictograms



Carton  
Box

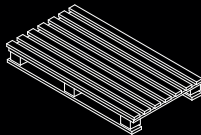

Palette Nimp15  
100 x 120 cm

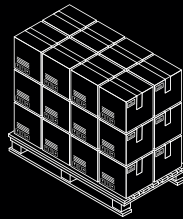

76 boxes per pallet of  
12 aerosols

## PROPERTIES

**Coverage capacity** : From 2 to 4m<sup>2</sup>, depending on covering power and to the nature of the support (colour, porosity)

**Autonomy** : 100 meters to have maximal coverage. Allows to realize 150 to 200 meters of marking within the speed of application and of covering wished..

**Drying time** : About 10 minutes at 20°C  
Ideal storage between 15 to 25°C, do not freeze

**Shelf life** : 4 years warranty

Usable with the gun handle and the one-wheel applicator



## SAFETY CAP

FLUO TP is fitted with the patented Soppec «TP» safety cap. The unique design of this cap gives it the following advantages :

- Protection against accidental tripping during transport or handling
- Protection of the user's hands against painting projections
- Easy to use
- The strongest safety cap on the market : No break when a full aerosol falls 1.50m (Test carried out on asphalt)
- A fine and precise spray which allows the realization of clear markings
- Cap denotes colour of the paint.

## GENERAL CONDITIONS

- Do not expose to temperatures above 50°C
- Keep away from sources of ignition, heat and sunlight
- Do not smoke
- Do not pierce even after use the aerosol
- Do not burn even after use the aerosol